Emergency Services Plan

0 Dietrich Road Solar Energy Facility

Applicant:

Dietrich Road Solar 1, LLC

For Activities At:

0 Dietrich Road

Hampshire, Illinois 60140

Prepared by:



New Leaf Energy

55 Technology Drive, Suite 102

Lowell, MA 01851

Dated: June 5, 2024



Table of Contents

1.	Emergency Action Plan Overview.....	1
2.	Construction Emergency Response Plan.....	1
3.	Pre-Emergency Planning.....	1
4.	Emergency Equipment and Supplies	2
5.	Incident Response	2
6.	Emergency Medical Treatment.....	3
7.	Evacuation.....	3
8.	Inclement Weather	4
9.	Emergency Directions	5
10.	Evacuation Route/Aerial Map	7
11.	Emergency Contacts.....	7



1. Emergency Action Plan Overview

Dietrich Road Solar 1, LLC is developing approximately 30 acres of land into a 4.99 MW-AC solar energy facility. The project area is located at 0 Dietrich Road near Hampshire, IL.

This report evaluates the Emergency Action Plan (EAP) and the necessary steps to be taken if hazardous situations arise at the project site. It relays the responsibilities of onsite safety personnel and the Emergency Response Coordinator (ERC) in such scenarios. Evacuation routes, procedures, and equipment needed to effectively execute the EAP are included here. Additionally, contact information and directions to the Hampshire Fire Protection District and Northwestern Medicine Huntley Hospital can be found in this report.

2. Construction Emergency Response Plan

The EAP will take effect in the case of a Safety, Fire or Medical Emergency. The plan will be initiated by three horn blasts and followed with radio or cellular communications as applicable. Once the three horn blasts are heard, supervision must immediately clear the air waves of all non-essential traffic and wait for further instruction, as applicable. All incident responders should communicate with the Contractor Emergency Response Coordinator (ERC). The ERC will coordinate with all municipalities prior to the start of the project to provide them with a scope of work, emergency procedures and how to access the site.

3. Pre-Emergency Planning

The Emergency Response Coordinator (ERC), which is the onsite safety manager, will perform applicable pre-emergency planning tasks before starting field activities and will coordinate emergency response with onsite personnel, the facility, and the local emergency service providers. These activities include the following:

- Ensure that there is a good contact list for all personnel onsite See Section 11.
- Verify that two-way radio communications are available and serviceable.
- Verify that all emergency contact information is correct and up to date.
- Post “Exit and Fire Extinguishers” signs above exit doors and above locations of fire extinguishers, also keep area exits and fire extinguisher access clear.
- Evaluate site condition, onsite operations, and personnel availability for emergency response procedures.
- Take an inventory of the site’s equipment, supplies and potable water.
- Visit with local fire department, EMS, and coordinate with a local doctor’s office to handle advanced first-aid incidents.



- Locate local hospital for emergency situations.
- Communicate emergency procedures for site hazards such as personal injury, exposures, fires, explosions, and releases.
- Brief new workers on the emergency action plan and evaluate emergency response actions during each new hire.

4. Emergency Equipment and Supplies

The onsite Safety Coordinator will ensure the following emergency equipment is on site and that the equipment is functional and serviceable. The Safety Coordinator will also note the locations of equipment and communicate that to all employees.

Emergency Equipment and Supplies include:

- Appropriate number and size of Class A, B, and C Fire Extinguisher based on construction site and construction activities
- Medical Jump Bag
- First Aid kit located in office
- AED
- Potable water
- Blood borne Pathogen Kit
- Additional equipment needed for site specific reasons
- Spill Kits
- Spill containment systems as required
- Lightning monitor
- Wet Bulb Globe Temperature meter

5. Incident Response

In case of a fire, explosion, or chemical release, please follow the steps below:

- Alert the appropriate response personnel, Hampshire Fire Protection District.
- Shut down operations and evacuate the immediate work area.
- Perform a head count of the designated assembly area(s).
- Assess the need for site evacuation, and evacuate the site as warranted.
- Conduct Incident Notification, Reporting and Investigation as required by OSHA and employer.



- Notify and submit reports to the clients, owners, and municipals as required.

Please note: Fires or spills that present a minimal safety or health hazard may be controlled with onsite spill kits or fire extinguishers without activating the sites evacuation procedure. When in doubt evacuate.

6. Emergency Medical Treatment

If emergency medical treatment is needed, whether life threatening or not, it must be immediately reported to site safety ERC. The ERC will evaluate the course of action that is needed. Major medical emergencies include injuries of severe bleeding, loss of consciousness, breathing or heart failure. A minimum of two first aid, CPR and AED trained persons shall be always onsite for medical emergencies. In the event of such, please follow the steps below:

- Notify Safety personnel.
- Notify 911 or other appropriate emergency response authorities that are listed at the site.
- Initiate first aid and CPR and AED if needed.
- Make certain that the injured person is accompanied by Safety personnel to the doctor or emergency room.

7. Evacuation

The site map should have clear detailed evacuation routes, assembly areas, severe weather shelters as well as any alternative routes and assembly locations.

- The Contractor primary muster point is just south of the project access road entrance.
- The Contractor secondary muster is the secondary access road east of the site.
- If site evacuation is needed, Hampshire Fire Protection District will become the muster point.
- The evacuation routes are shown on the map in Section 10.
- All members of staff will gather at the muster point upon hearing the emergency signal for evacuation.
- The Safety personnel and a “buddy” will remain on the site after the site has been evacuated if the situation is safe to assist local responders.
- The Safety team will account for all personnel in the onsite assembly area.
- A designated person will account for personnel at alternate muster area(s).



- The Safety Coordinators will follow the incident reporting protocols.

8. Inclement Weather

Sudden inclement weather can infringe upon field personnel. Emergency preparedness and caution are the best defense. Field crew members performing work outdoors should carry the appropriate clothing for this type of weather. Staff should pay close attention to the weather forecast on a daily basis to look for signs of inclement weather. These signs include towering thunderheads, darkening skies, or a sudden increase in wind. If stormy weather ensues, field personnel should discontinue work and seek shelter until the storm has passed. Stay away from open water, metal equipment, wire fences and metal pipes.

Other general precautions include, but are not limited to:

- Know where to go and how long it will take to get there. If possible, take refuge in a large building or vehicle. Do not go into a shed in an open area.
- Avoid standing under large trees, poles, antennas, and towers.
- If the area is wide open, go to a valley or ravine, but be aware of flash flooding.
- If you are caught in a level open area during an electrical storm, bend forward and crouch. This technique will make you less vulnerable to electrocution.
- Do not lie down. This is dangerous and can cause the wet earth to conduct electricity.
- Do not touch the ground with your hands.
- Do not use telephones during electrical storms, except in the case of emergency.
- Remember: lightning can strike several miles from the parent cloud, so work should be stopped and restarted accordingly.
- Lightning safety recommendation is 30-30, translating to seeking protection when thunder sounds within 30 seconds after a lightening flash and do not resume work until 30 minutes after the last thunderclap. Stay alert for high winds that can cause unsafe conditions. Working in high wind conditions should be avoided. If continuous high wind persists, then staff should seek shelter. All employees will stand down when lightning reaches a range of 8 Miles.



9. Emergency Directions

9.1. Hospital Directions

Dietrich Rd

Hampshire, IL 60140

- > Take Briar Hill Rd/Brier Hill Rd to Co Hwy 31/Harmony Rd/Harmony Huntley Rd in Coral Township

2 min (1.3 mi)

- > Continue on Co Hwy 31. Take Main St and W Algonquin Rd to Haligus Rd in Huntley

9 min (4.8 mi)

- > Follow Haligus Rd and Faiths Way to your destination

1 min (0.3 mi)

Northwestern Medicine Huntley Hospital

10400 Haligus Rd, Huntley, IL 60142

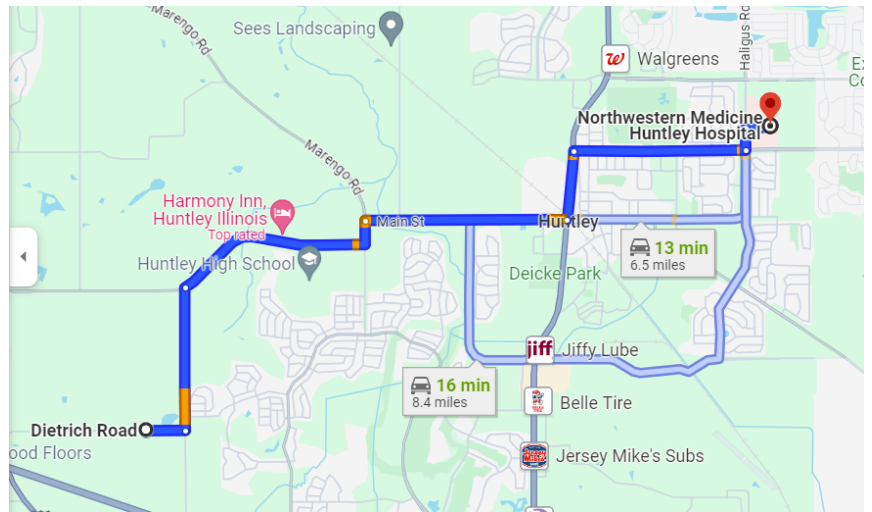

Project – Dietrich Road Solar

Project Address – 0 Dietrich Road, Hampshire, IL 60140

Hospital – Northwestern Medicine Huntley Hospital

Hospital Address - 10400 Haligus Road, Huntley, IL 60142

Directions from Project to Hospital

Head east on Dietrich Road

Turn left onto Brier Hill Road

Turn right onto Harmony Road

Turn right onto Main Street

Turn left onto IL-47 N

Turn right onto W Algonquin Road

Turn left onto Haligus Road

Turn right onto Faiths Way

The destination is on the left



9.2. Fire Department Directions

Dietrich Rd

Hampshire, IL 60140

- ↑ Head west on Dietrich Rd
1.1 mi
- ↶ Turn left onto US-20 E
0.5 mi
- ↷ Turn right onto Higgins Rd
0.3 mi
- ↶ Turn left onto Widmayer Rd
2.3 mi
- ↷ Turn right onto Allen Rd
1.0 mi
- ↶ Turn left onto N State St
0.5 mi
- ↶ Turn left onto Washington Ave
0.1 mi
Destination will be on the left

Hampshire Fire Protection District
202 Washington Ave, Hampshire, IL 60140

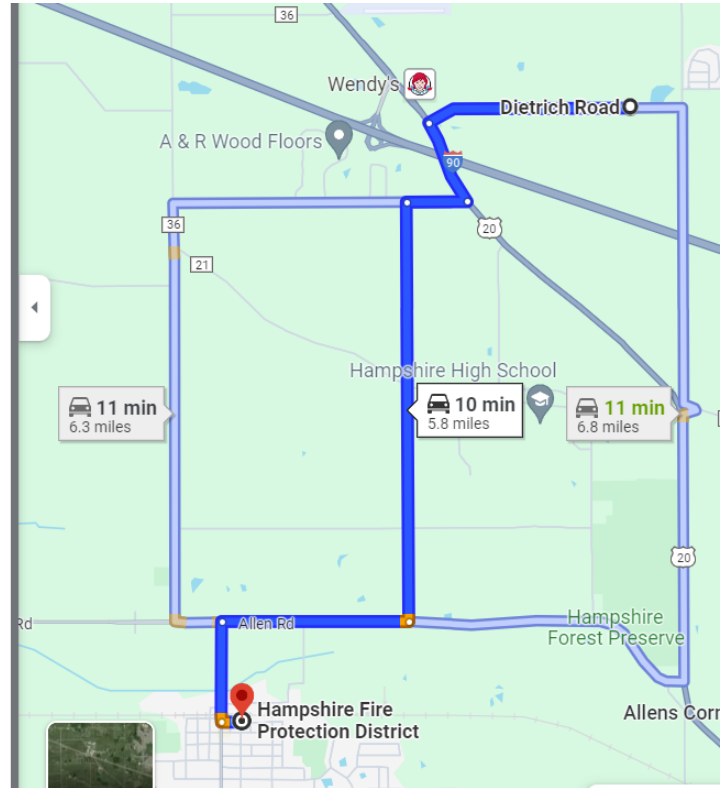

Project – Dietrich Road Solar

Project Address – 0 Dietrich Road, Hampshire, IL 60140

Fire Department – Hampshire Fire Protection District

Fire Department Address – 202 Washington Avenue, Hampshire, IL 60140

Directions from Project to Fire Department

Head west on Dietrich Road

Turn left onto US-20 E

Turn right onto Higgins Road

Turn left onto Widmayer Road

Turn right onto Allen Road

Turn left onto N State Street

Turn left onto Washington Avenue

Destination will be on the left



10. Evacuation Route/Aerial Map

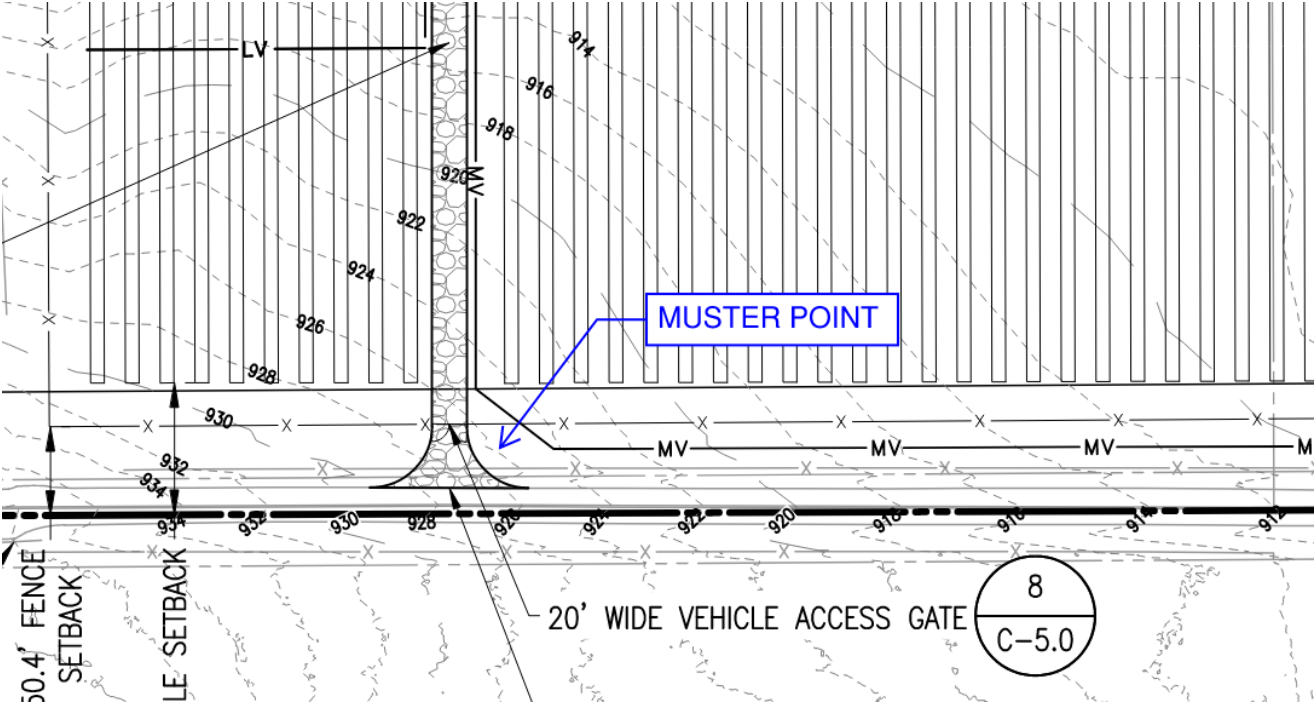

11. Emergency Contacts

IN THE EVENT THAT THERE IS AN EMERGENCY THE AIR HORN WILL SOUND. AFTER THE HORN THERE WILL BE A MESSAGE INDICATING THE TYPE OF EMERGENCY FOLLOWED BY DIRECTION.

IMMEDIATE MUSTER POINT: SOUTH OF PROJECT ACCESS ROAD ENTRANCE

ALTERNATE: EASTERN SECONDARY ACCESS ROAD FOR FACILITY POLE FARM

OFFSITE MUSTER POINT: HAMPSHIRE FIRE PROTECTION DISTRICT

Construction Contractor, SAFETY MANAGER (ERC):

--	--	--

FIRE:

Hampshire Fire Protection District	202 Washington Avenue, Hampshire, IL 60140	(847) 683-2629
------------------------------------	---	----------------



HOSPITAL:

Northwestern Medicine Huntley Hospital	10400 Haligus Road, Huntley, IL 60142	(224) 654-0000
---	--	----------------

MEDICAL/FIRST AID CLINIC:

Advocate Clinic	12000 Princeton Dr, Huntley, IL 60142	(800) 323-8622
-----------------	--	----------------

POLICE DEPARTMENT:

Hampshire Police Department	215 Industrial Dr, Hampshire, IL 60140	(847) 683-2240
--------------------------------	---	----------------

ALTERNATE EMERGENCY CALL: 911