

ZONING MAPS
of
KANE COUNTY, ILLINOIS
MAP NO. CA-35
MAP SCALE
0 100 200 300 400 500
FEET

Kane County, Illinois
Building and Zoning Division

Mark D. Vankerhoff, AIA
Zoning Enforcing Officer

Kane County
Government Center
719 S. Batavia Ave.
Bldg. A, 4th Floor
Geneva, IL 60134

Phone: 630.232.3492

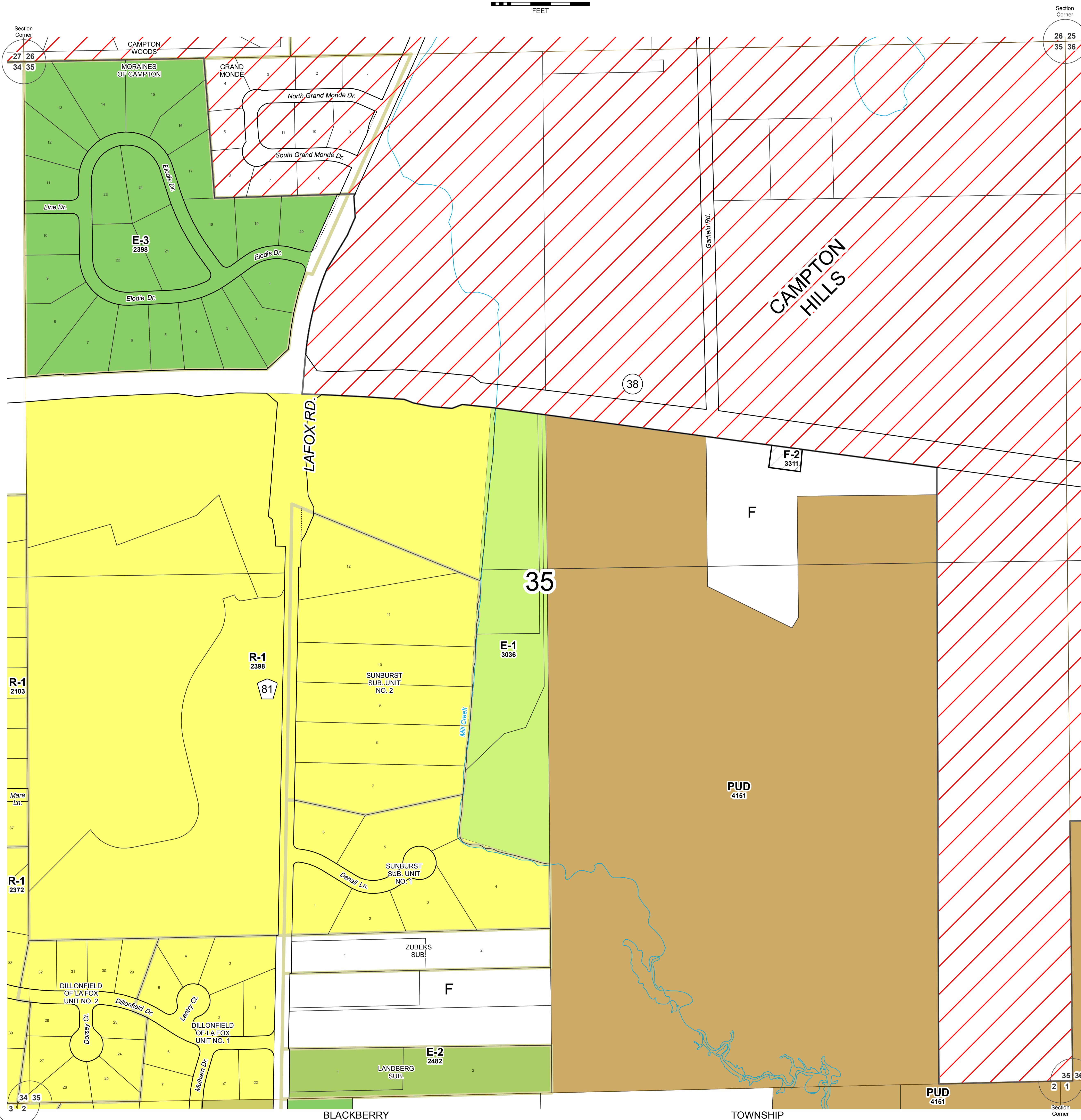

ZONING LEGEND		
FARMING DISTRICT	F	[White]
	F-1	[Light Gray]
	F-2	[Diagonal Lines]
RESIDENTIAL DISTRICT	E-1	[Light Green]
	E-2	[Medium Green]
	E-2A	[Light Yellow-Green]
	E-3	[Medium Green]
	R-1	[Light Yellow]
	R-2	[Light Orange]
	R-3	[Orange]
	R-4	[Dark Orange]
	R-5	[Red]
R-6		
R-7		
R-8		
R-9	[Dark Brown]	
RB	[Light Blue]	
BUSINESS DISTRICT	B-1	[Light Blue]
	B-2	[Medium Blue]
	B-3	[Teal]
	B-4	[Dark Blue]
	B-5	[Dark Teal]
	B-6	[Dark Blue]
SPECIAL INDUSTRIAL DISTRICT	LI	[Pink]
	I	[Purple]
AIRPORT DISTRICT	PUD	[Brown]
	A-1	[Light Green]
OTHER	A-2	[Light Green]
	SU	[Diagonal Lines]
	Incorporated	[Red Hatched]
	Forest Preserve	[Dark Green]

SECTION 35
CAMPTON TOWNSHIP

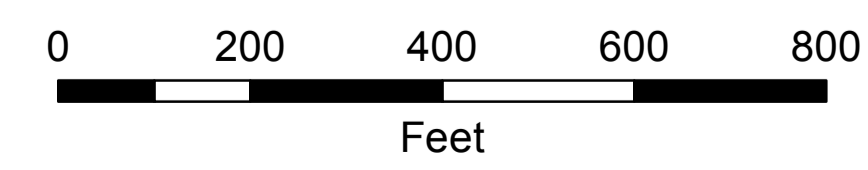

Revisions	
7/07 - BRB	

Digital Zoning Maps created September 9, 2003 (TMV, TJM)

Base data current as of February 28, 2019.

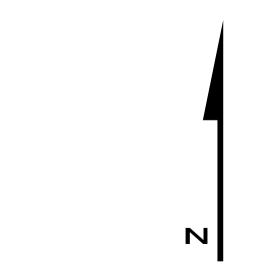

CA-35 ZONING