

ZONING MAPS  
of  
KANE COUNTY, ILLINOIS  
MAP NO. BL-31  
MAP SCALE  
0 100 200 300 400 500  
FEET

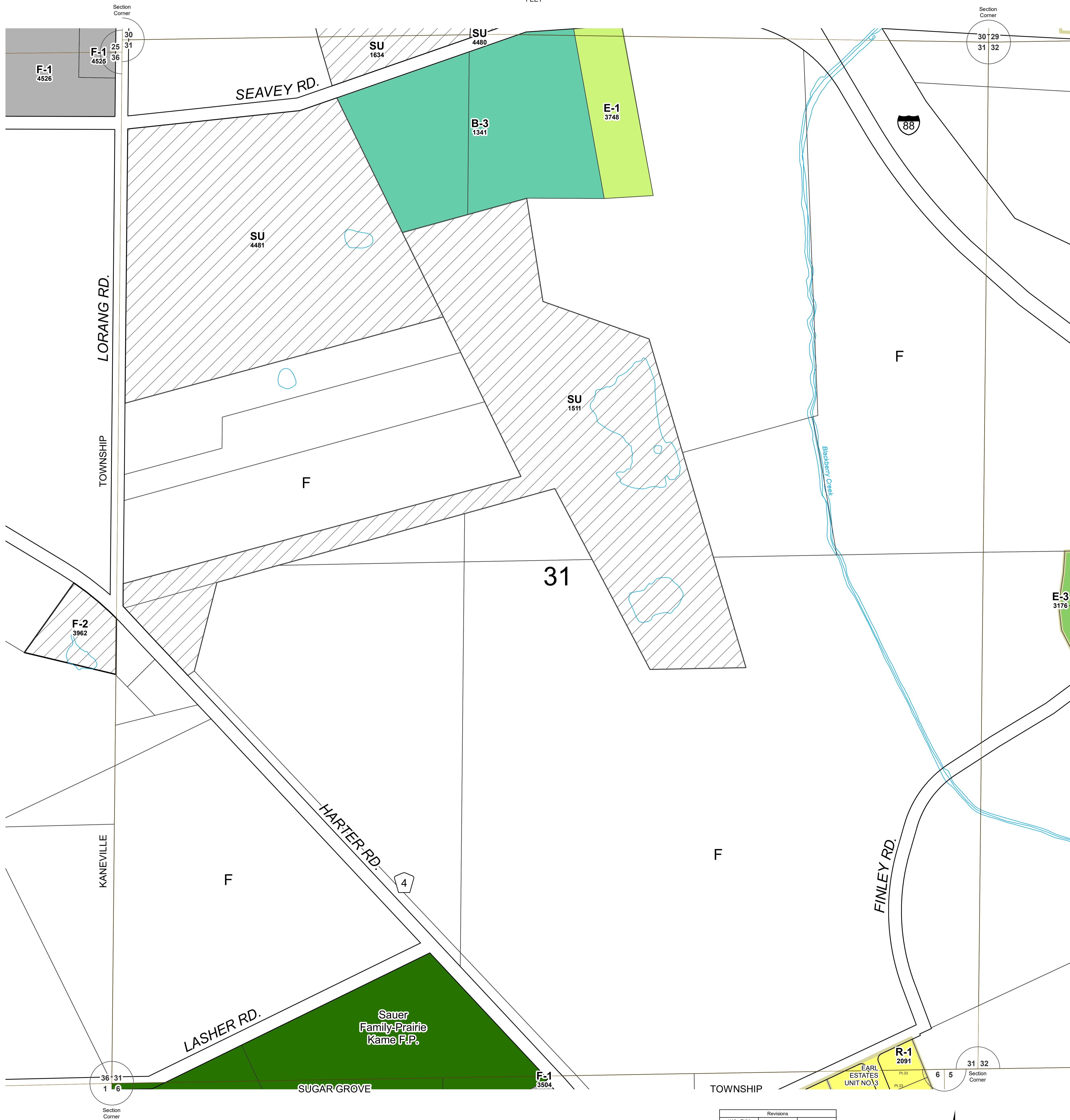

SECTION 31  
BLACKBERRY TOWNSHIP

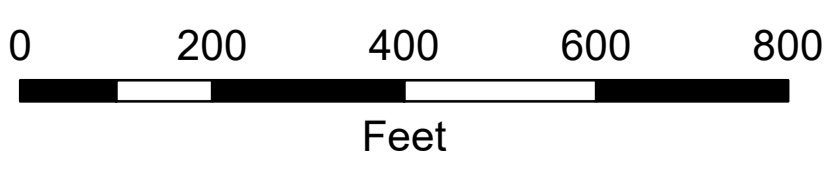

Revisions	
1/19 - TJM	
3/19 - TJM	

Digital Zoning Maps created September 9, 2003 (TJM, TJM)  
Base data current as of July 31, 2020.

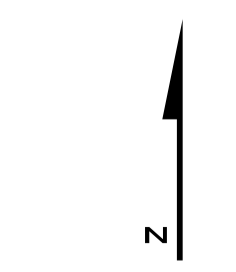

BL-31 ZONING

Kane County, Illinois  
Building and Zoning Division

Mark D. Vankerkhoff, AIA  
Zoning Enforcing Officer

Kane County  
Government Center  
719 S. Batavia Ave.  
Bldg. A, 4th Floor  
Geneva, IL 60134

Phone: 630.232.3492

ZONING LEGEND		
FARMING DISTRICT	F	[White Box]
	F-1	[Grey Box]
	F-2	[Hatched Box]
RESIDENTIAL DISTRICT	E-1	[Light Green Box]
	E-2	[Medium Green Box]
	E-2A	[Yellow-Green Box]
	E-3	[Green Box]
	R-1	[Yellow Box]
	R-2	[Light Orange Box]
	R-3	[Orange Box]
	R-4	[Dark Orange Box]
	R-5	[Red-Orange Box]
R-6		
R-7		
R-8	[Brown Box]	
R-9		
BUSINESS DISTRICT	RB	[Light Blue Box]
	B-1	[Light Blue Box]
	B-2	[Medium Blue Box]
	B-3	[Green-Blue Box]
	B-4	[Dark Blue Box]
	B-5	[Dark Green Box]
INDUSTRIAL DISTRICT	LI	[Pink Box]
	I	[Purple Box]
SPECIAL DISTRICT	PUD	[Brown Box]
AIRPORT DISTRICT	A-1	[Light Green Box]
	A-2	[Light Green Box]
OTHER	SU	[Hatched Box]
	Incorporated	[Red-White Box]
	Forest Preserve	[Green Box]