

ZONING MAPS  
of  
KANE COUNTY, ILLINOIS  
MAP NO. BL-29  
MAP SCALE  
0 100 200 300 400 500  
FEET

Kane County, Illinois  
Building and Zoning Division

Mark D. Vankerhoff, AIA  
Zoning Enforcing Officer

Kane County  
Government Center  
719 S. Batavia Ave.  
Bldg. A, 4th Floor  
Geneva, IL 60134

Phone: 630.232.3492

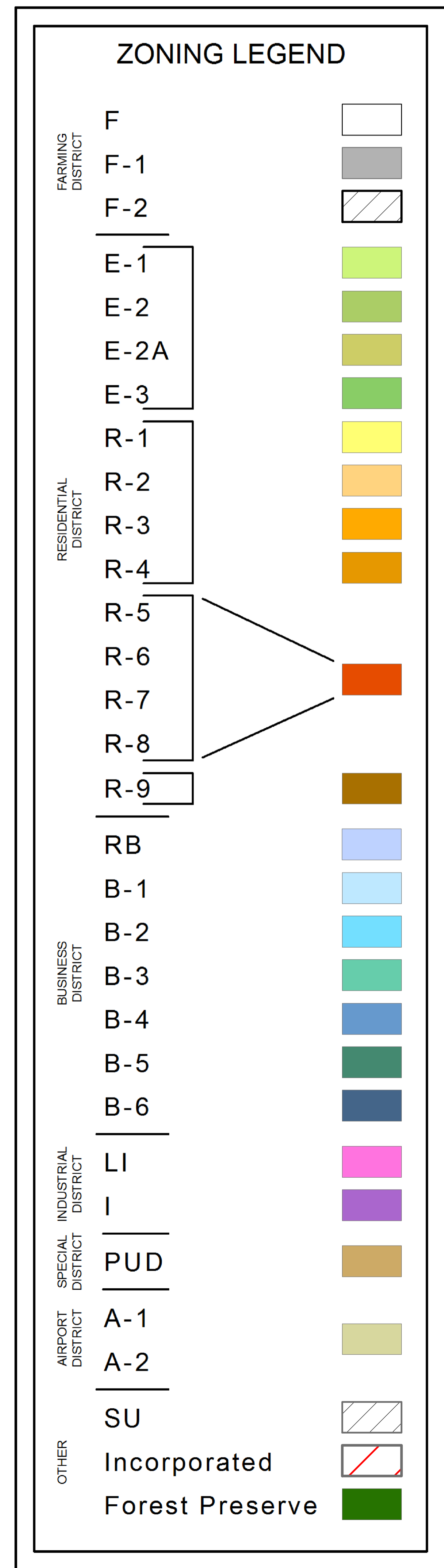
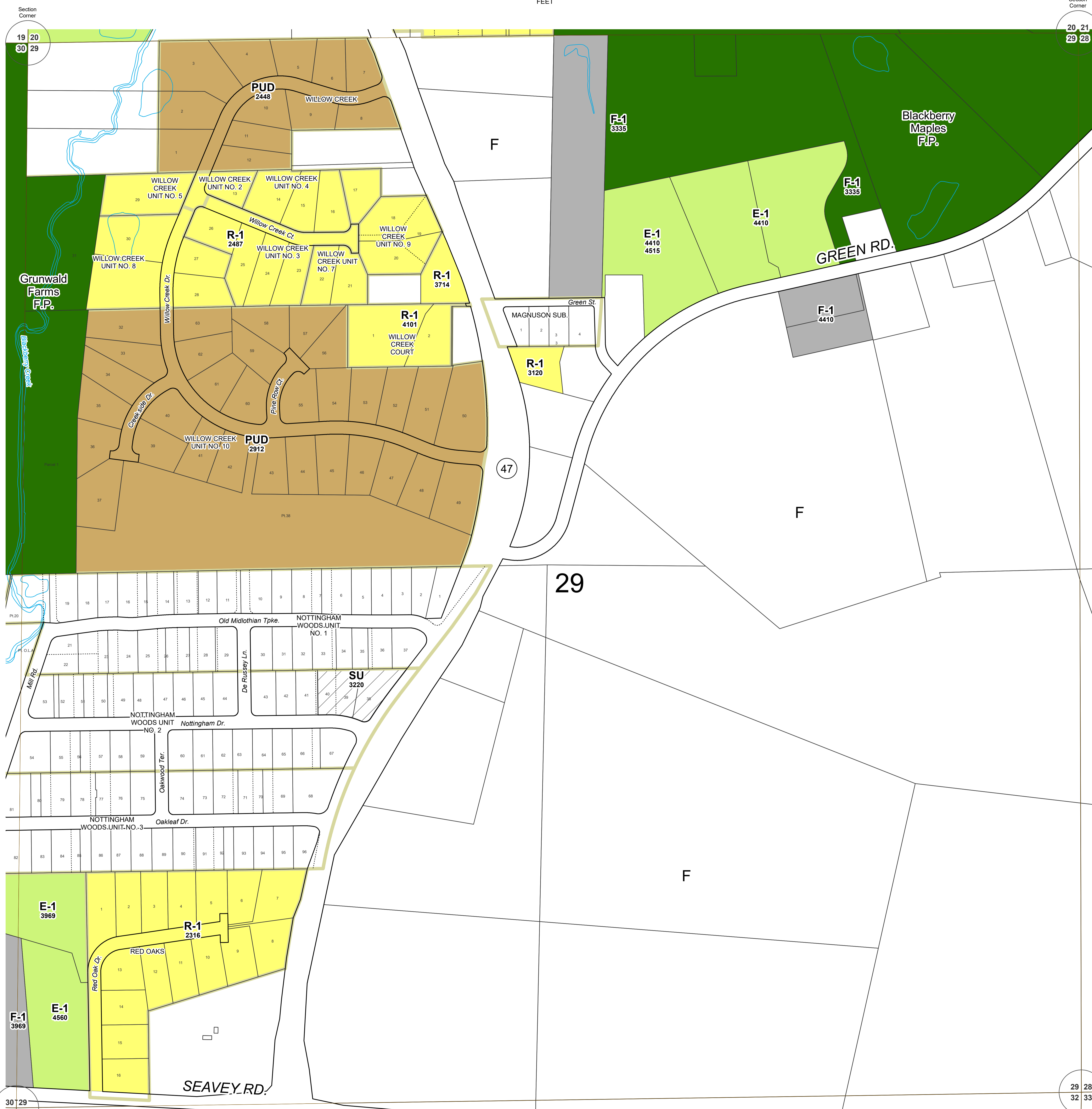

SECTION 29  
BLACKBERRY TOWNSHIP

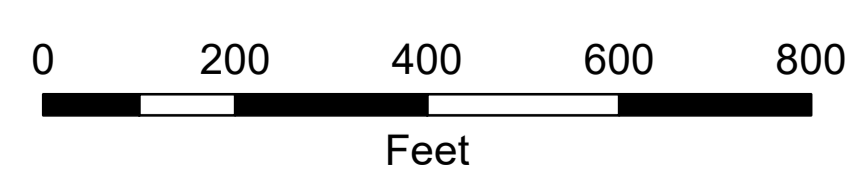

Revisions	
3/04 - TMV	
9/08 - BRB	
2/17 - TJM	
9/19 - TJM	
11/20 - TJM	

Base data current as of October 31, 2020.

BL-29 ZONING