

ZONING MAPS  
of  
KANE COUNTY, ILLINOIS  
MAP NO. BL-05  
MAP SCALE  
0 100 200 300 400 500  
FEET

Kane County, Illinois  
Building and Zoning Division

Mark D. Vankerkhoff, AIA  
Zoning Enforcing Officer

Kane County  
Government Center  
719 S. Batavia Ave.  
Bldg. A, 4th Floor  
Geneva, IL 60134

Phone: 630.232.3492

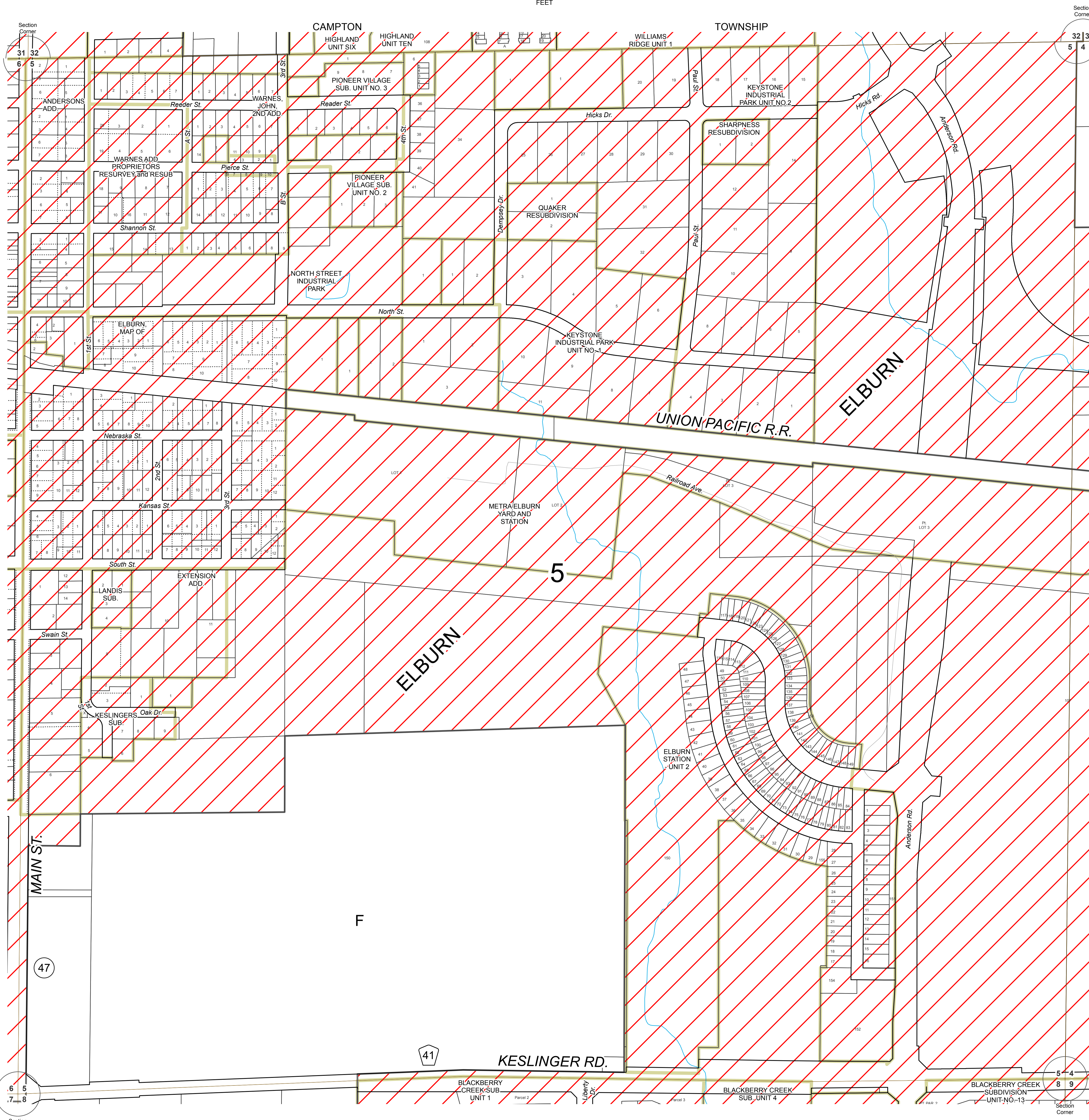

ZONING LEGEND		
FARMING DISTRICT	F	[White Box]
	F-1	[Grey Box]
	F-2	[Hatched Box]
RESIDENTIAL DISTRICT	E-1	[Light Green Box]
	E-2	[Green Box]
	E-2A	[Yellow-Green Box]
	E-3	[Green Box]
	R-1	[Yellow Box]
	R-2	[Orange Box]
	R-3	[Orange Box]
	R-4	[Orange Box]
	R-5	[Orange Box]
R-6	[Red-Orange Box]	
R-7	[Red-Orange Box]	
R-8	[Red-Orange Box]	
R-9	[Brown Box]	
BUSINESS DISTRICT	RB	[Light Blue Box]
	B-1	[Light Blue Box]
	B-2	[Light Blue Box]
	B-3	[Light Blue Box]
	B-4	[Light Blue Box]
	B-5	[Light Blue Box]
SPECIAL INDUSTRIAL DISTRICT	LI	[Pink Box]
	I	[Purple Box]
AIRPORT DISTRICT	PUD	[Brown Box]
	A-1	[Light Green Box]
OTHER	A-2	[Light Green Box]
	SU	[Hatched Box]
	Incorporated	[Hatched Box]
	Forest Preserve	[Dark Green Box]

SECTION 5  
BLACKBERRY TOWNSHIP

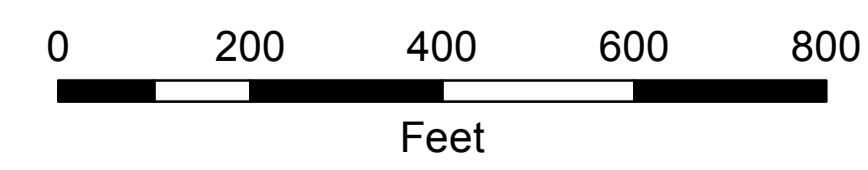

Revisions	

Digital Zoning Maps created September 9, 2003 (TMV, TJM)

Base data current as of January 31, 2019.

BL-05 ZONING