

ZONING MAPS
of
KANE COUNTY, ILLINOIS
MAP NO. AU-10
MAP SCALE
0 100 200 300 400 500
FEET

Kane County, Illinois
Building and Zoning Division

Mark D. Vankerkhoff, AIA
Zoning Enforcing Officer

Kane County
Government Center
719 S. Batavia Ave.
Bldg. A, 4th Floor
Geneva, IL 60134

Phone: 630.232.3492

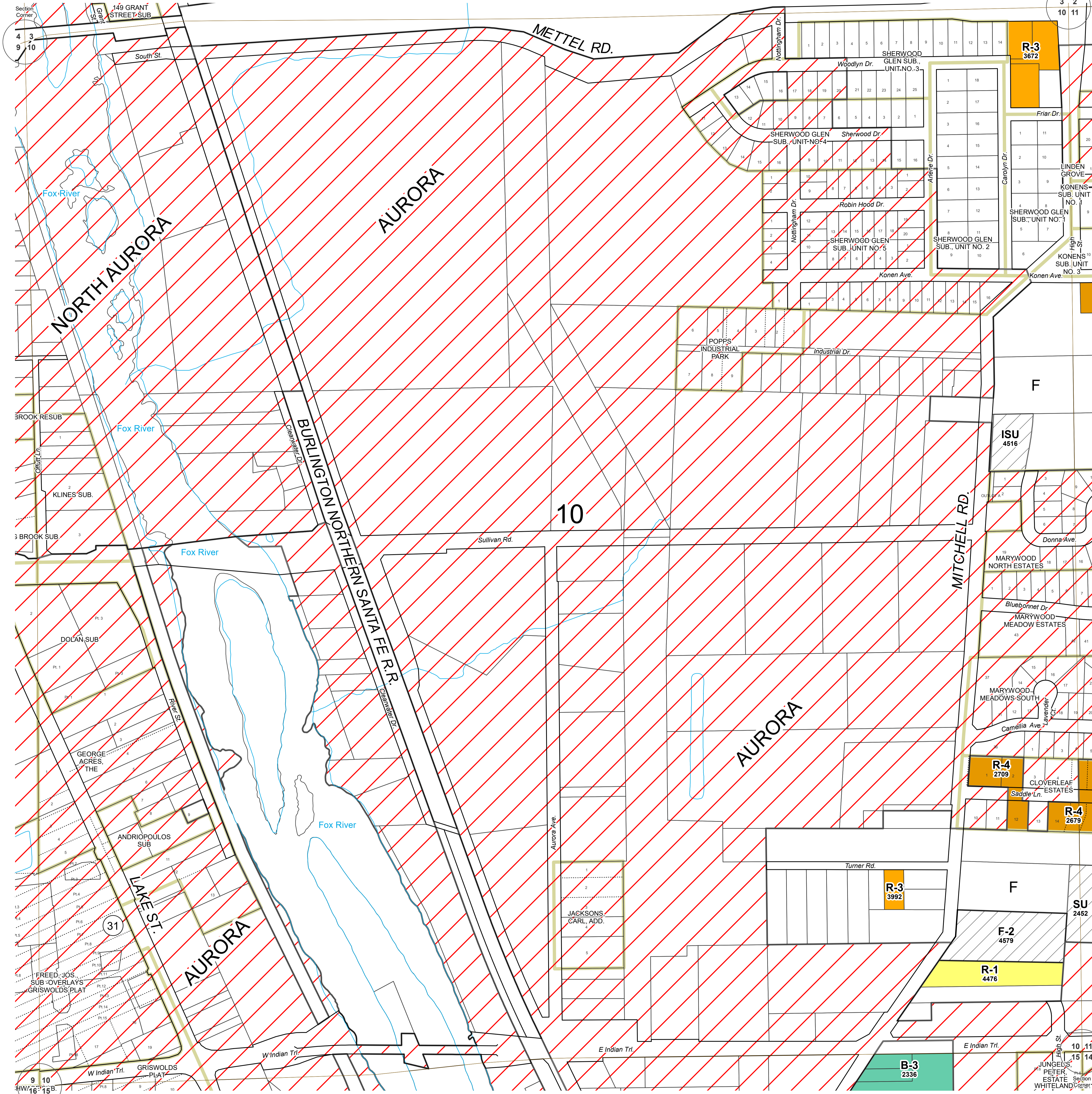

| ZONING LEGEND | | |
|-----------------------------|-------------------|--------------------------|
| FARMING DISTRICT | F | [White Box] |
| | F-1 | [Grey Box] |
| | F-2 | [Diagonal Lines Box] |
| RESIDENTIAL DISTRICT | E-1 | [Light Green Box] |
| | E-2 | [Medium Green Box] |
| | E-2A | [Light Yellow-Green Box] |
| | E-3 | [Green Box] |
| | R-1 | [Yellow Box] |
| | R-2 | [Light Orange Box] |
| | R-3 | [Orange Box] |
| | R-4 | [Dark Orange Box] |
| | R-5 | [Red-Orange Box] |
| R-6 | [Red Box] | |
| R-7 | [Dark Red Box] | |
| R-8 | [Dark Orange Box] | |
| R-9 | [Brown Box] | |
| BUSINESS DISTRICT | RB | [Light Blue Box] |
| | B-1 | [Light Blue Box] |
| | B-2 | [Medium Blue Box] |
| | B-3 | [Dark Blue Box] |
| | B-4 | [Teal Box] |
| | B-5 | [Dark Teal Box] |
| SPECIAL INDUSTRIAL DISTRICT | LI | [Pink Box] |
| | I | [Purple Box] |
| AIRPORT DISTRICT | PUD | [Brown Box] |
| | A-1 | [Light Green Box] |
| OTHER | A-2 | [Light Green Box] |
| | SU | [Diagonal Lines Box] |
| | Incorporated | [Red Hatched Box] |
| | Forest Preserve | [Dark Green Box] |

SECTION 10
AURORA TOWNSHIP

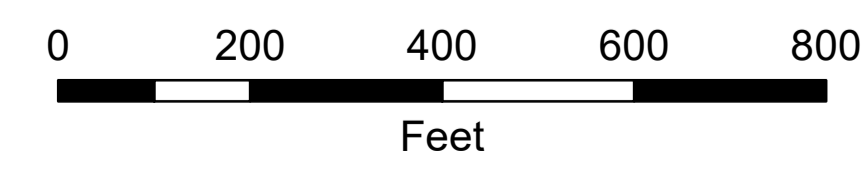

| Revisions | |
|-------------|--|
| 8/04 - TMV | |
| 12/18 - TJM | |
| 9/19 - TJM | |
| 9/21 - TJM | |

Digital Zoning Maps created September 9, 2003 (TMV, TJM)

AU-10 ZONING

Base data current as of May 31, 2011.